

Project: **Valuation of assets at potash mining "Zielitz"**

Client: K+S KALI GmbH
Werk Zielitz
Farsleber Straße 1
39326 Zielitz
Germany



Evaluation: Industrial building sites

Industrial area: 800,000 m²

Date: 2003 - 2004

Project description:

Survey of industrial buildings to estimate the values for fire insurance

- Structural state
- Evaluation of existing plans, tachymetric building measurements
- Design of data sheets, system drawings, layouts
- Calculation of volume and site areas
- Classification of the industrial building sites
- Photo-documentation
- Evaluation of fire insurance values



Services:

HOAI § 34 (German regulation for engineers), valuation of assets

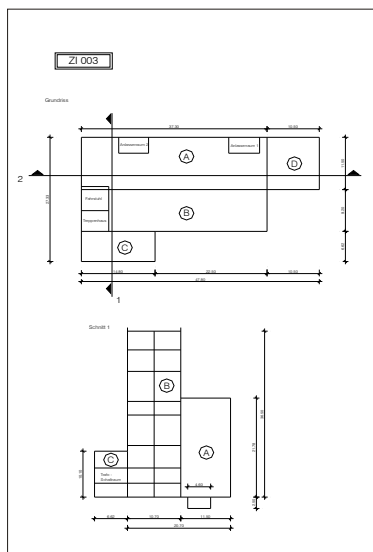

System drawing

ZI 003				990,98 m ²
Art. Nr. 9110001				24.000,83 m ²
Openwork space				
Tab A	27,20 m	11,50 m	+	428,90 m ²
Tab B	27,20 m	9,20 m	+	345,16 m ²
Tab C	14,80 m	6,50 m	+	98,20 m ²
Tab D	11,50 m	10,50 m	+	120,75 m ²
				992,91 m²
Enclosed space				
Tab A	22,20 m	11,50 m	+	2,542,50 m ²
Tab B	27,20 m	9,20 m	+	10,826,34 m ²
Tab C	14,80 m	6,50 m	+	1,911,50 m ²
Tab D	11,50 m	10,50 m	+	1,495,20 m ²
	207,70 m	4,60 m	+	2,248,80 m ²
	9,50 m	4,00 m	+	2,39 m ²
			1/2	24.000,83 m²

Data sheet

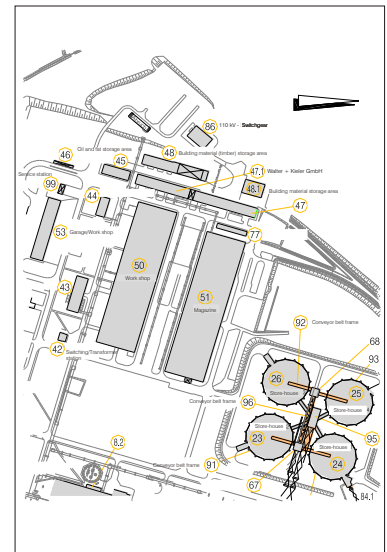

Layout